

TL29

series



Product Segments

- **Ergo Motion**

TiMOTION's TL29 series lifting columns are specifically designed for use in ergonomic desks and work tables. Using multiple TL series lifting columns with compatible TC series control boxes and TH / TDH series controls, work surfaces can be controlled quietly and smoothly with synchronous movement. All Ergo Motion TC series control boxes have a less than 0.1W standby power option that reduces power consumption. Our wide range of columns offers customers the solutions they require to satisfy their project requirements. The TL29 has a two stage telescopic outer tube that is designed for a wide-top, narrow-bottom round appearance. One single TL29 can lift maximum 80KG. Various powder coating is available.

General Features

Max. load	800N (push)
Max. speed at max. load	28mm/s
Max. speed at no load	46mm/s
Retracted length	645mm
Dimension of outer tube	2-stage, Ø70mm round, upside down
Stroke	500mm
Color	Black, white, grey, or special colors

Drawing

Standard Dimensions
(mm)

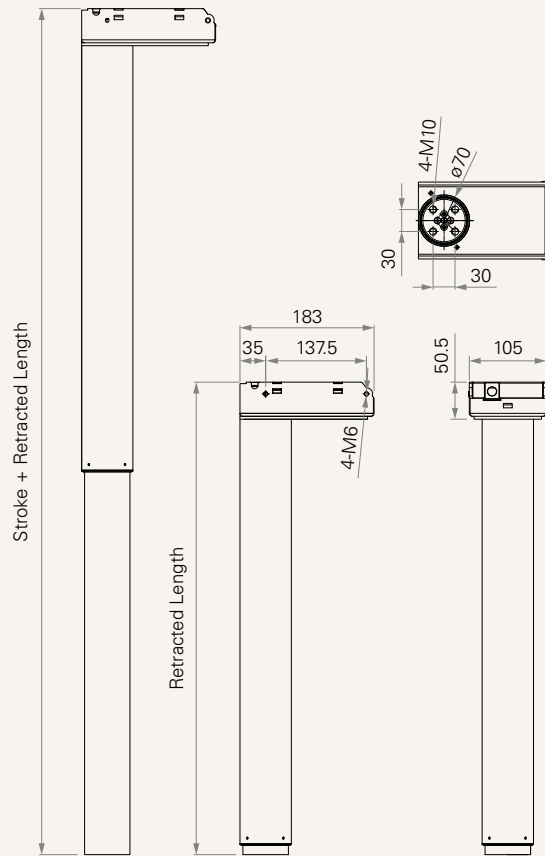

Load and Speed

CODE	Load (N)	Self Locking Force (N)	Typical Current (A)		Typical Speed (mm/s)	
	Push		No Load 32V DC	With Load 24V DC	No Load 32V DC	With Load 24V DC
Motor Speed (5200RPM)						
A	800	800	2.5	5.0	46.0	28.0

Note

- 1 This self-locking force level is reached only when a short circuit is applied on the terminals of the motor. All the TiMOTION control boxes have this feature built-in.
- 2 Please refer to the approved drawing for the final authentic value.

Performance Data (24V DC Motor)

Motor Speed (5200RPM)

Speed vs. Load

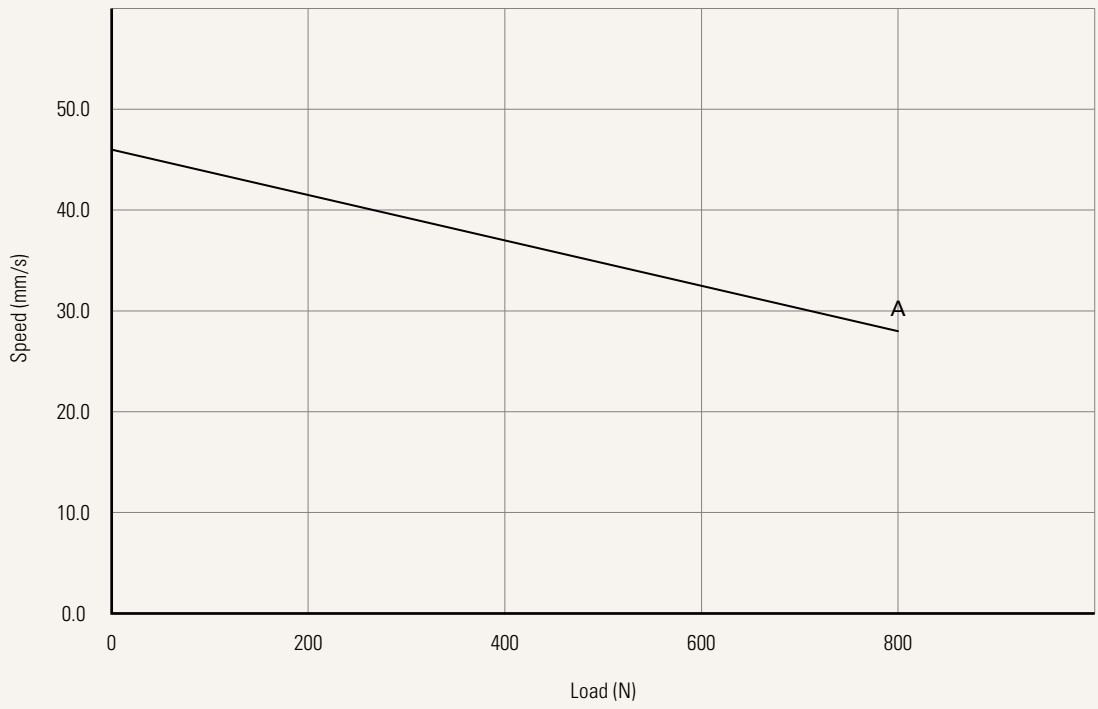

Current vs. Load

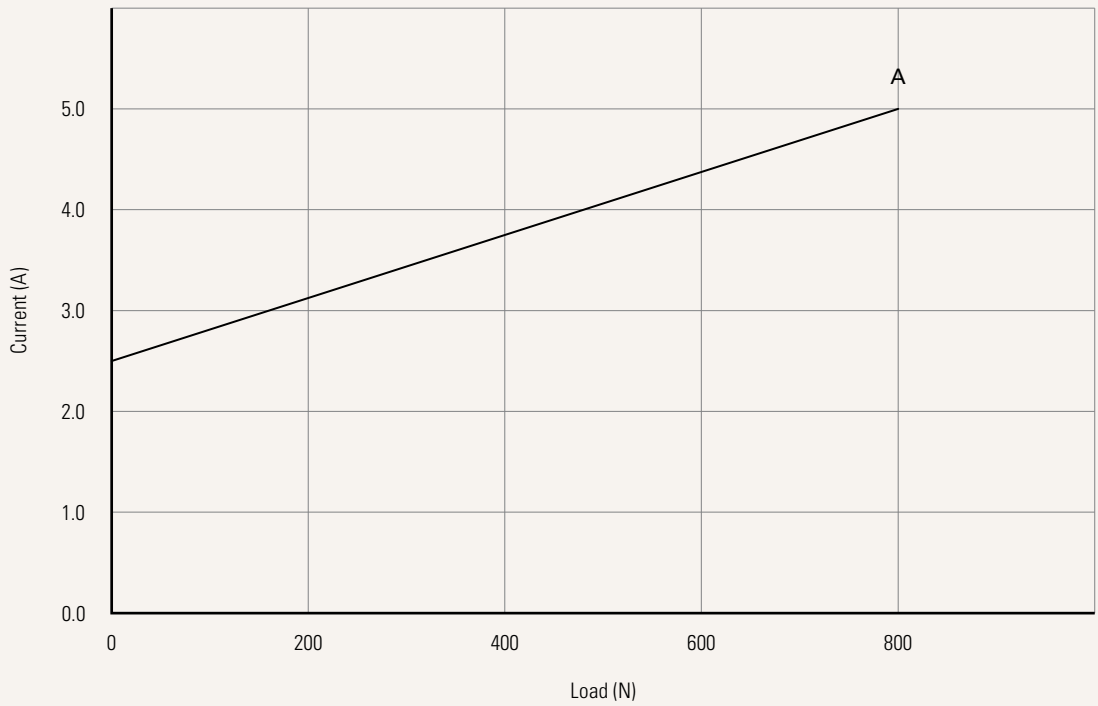

Note

1 The performance data in the curve charts shows theoretical value.

Appearance of Tubes See page 5	B = With wiper fixing holes at sides	C = Without wiper fixing holes at sides	
Voltage	2 = 24V DC		
Load and Speed	See page 2		
Stroke & Retracted Length (mm)	See page 5		
Color	1 = Black, RAL 9005, Black wiper 2 = Grey, RAL 9006, Black wiper 3 = White, RAL 9016, Black wiper 4 = Special grey, RAL 9022, Black wiper 6 = Grey, RAL 9006, Grey wiper	7 = White, RAL 9016, White wiper 8 = Special grey, RAL 9022, Grey wiper B = Matte black, RAL 7021, Black wiper C = Graphite grey, RAL7024, Black wiper D = Matte black, RAL 7021, Matte Black wiper	
Motor Housing Step	0 = With	1 = Without	
Output Signals	2 = Hall sensor*2		
Connector See page 5	1 = DIN 6P, 90° plug	E = Molex 8P, plug, standard	
Cable Length (mm)	1 = Straight, 500	3 = Straight, 1000	4 = Straight, 1500
Bracket	0 = Without		

Note

1 The TL29 is designed especially for push applications, not suitable for pull applications.

Stroke & Retracted Length (mm)

A. Stroke & Retracted Length

500 / 645

Connector

1 = DIN 6P, 90° plug

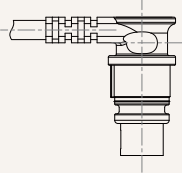

E = Molex 8P, plug, standard

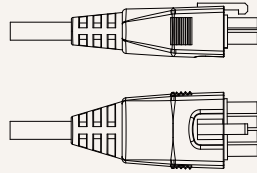

Appearance of tubes

B = With wiper fixing holes at sides

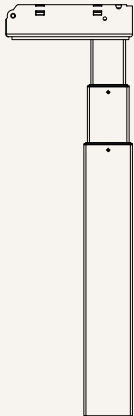

C = Without wiper fixing holes at sides

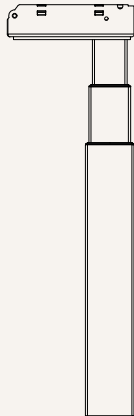

Terms of Use

The user is responsible for determining the suitability of TiMOTION products for a specific application. TiMOTION products are subject to change without prior notice.